



## ALP-PAL

### General Information

PALs provide full protection against the inherent dangers of fluorescent lamp breakage by retaining the shattered glass and phosphors. They are made of clear extruded polycarbonate, featuring high tensile strength over a wide temperature range and high impact strength even at low temperatures. PALs meet OSHA, FDA, NEC and USDA requirements. The U.S. Department of Agriculture requires meat packing plants to have acceptable protection for fluorescent lamps. The FDA requires lamps suspended over exposed food, in any step of preparation, must be of the safety type or otherwise protected to prevent food contamination in case of breakage. A.L.P. PALs allow lamps to meet these requirements.

Protect-A-Lamp sleeves provide exposed lamps protection against dirt, dust, bugs and flying insects. They reduce cleaning cycles and minimize lamp replacement due to breakage. These sleeves are for use in Museums, Art Galleries, Libraries, Department Stores, Food Processing Plants, Schools, Hospitals and other areas where contaminations may occur due to lamp breakage.

### Ultraviolet Filtering PALs

PALs U.V. composition shall effectively resist ultraviolet light emission because of the selective transmittance characteristics which filter out U.V. rays from 0 to 385 nanometers. Shall be made of extruded acrylic UVA-7 formulation.

### End Caps

End Caps are made of a snug fitting heat resistant polypropylene plastic. The caps will hold the lamps in place even if broken and will prevent the tubes from falling.

### Heat Sink Screens

Heat Sink Screens are used with high-output lamps. HO (800 MA) and VHO (1500 MA) lamps create excessive heat at the ends of the lamp. The open metal mesh spreads the excess heat of the lamp, eliminating deterioration of the plastic sleeve.

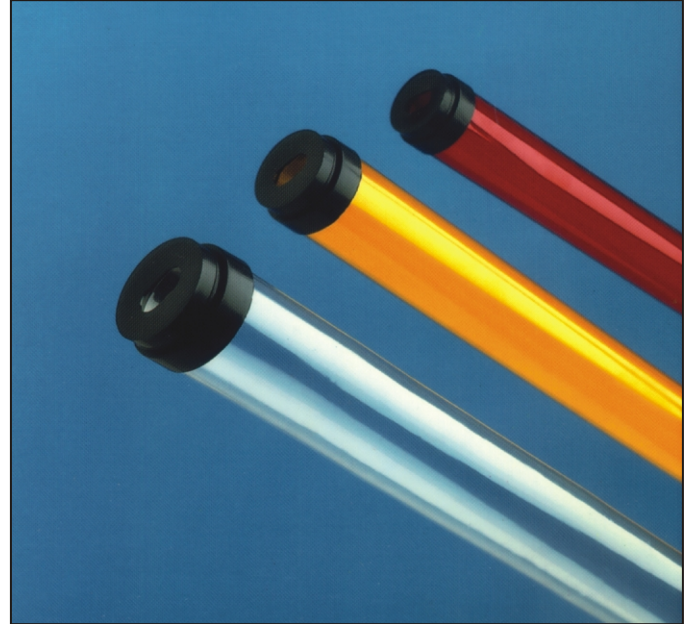

**ALP-PAL**

### Colors

Clear  
 Red  
 Green  
 Blue  
 Pink  
 Gold  
 Yellow  
**Clear-UVA-7**  
 (Ultraviolet Filtering)

MEETS SAFETY STANDARDS  
 Required By:

### **OSHA**

National Electrical Code  
 U.S. Dept. of Agriculture  
 Food and Drug

**For more information, or to place an order,  
 contact Customer Service.**

# ALP-PAL DATA



## Specifications

### Standard PAL's

PAL's as manufactured by A.L.P. Lighting Components, Inc., shall meet the safety standard requirements of **OSHA, NEC, FDA** and the **U.S. Department of Agriculture**. PAL's shall be made of polycarbonate, which has superior temperature and impact characteristics.

### Ultraviolet Filtering PAL's

PAL's U.V. composition shall effectively resist ultraviolet light emission because of the selective transmittance characteristics which filter out U.V. rays from 0 to 385 nanometers. Shall be made of extruded acrylic UVA 7 formulation.

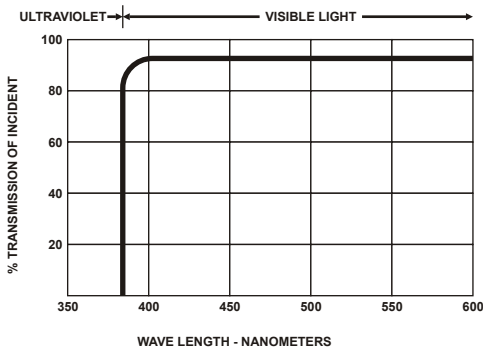

CATALOG NO.	COLOR	END CAP	LAMP DESCRIPTION
<b>T12 Lamps</b>			
PAL 40C	CLEAR	PAL C	F40 T12
PAL 48C	CLEAR	PAL C	F48 T12
PAL 72C	CLEAR	PAL C	F72 T12
PAL 96C	CLEAR	PAL C	F96 T12
PAL 96HOC	CLEAR	PAL C	F96 T12
PAL 96VHOC	CLEAR	PAL C	F96 T12
<b>T8 Lamps</b>			
PAL 18T8C	CLEAR	PAL T8	F15 T8
PAL 36T8C	CLEAR	PAL T8	F25 T8
PAL 40T8C	CLEAR	PAL T8	F32 T8
PAL 96T8C	CLEAR	PAL T8	F96 T8
<b>UV Filtering</b>			
PAL 40CUV	CLEAR UVA 7	PAL C	F40 T12
PAL 48CUV	CLEAR UVA 7	PAL C	F48 T12
PAL 72CUV	CLEAR UVA 7	PAL C	F72 T12
PAL 96CUV	CLEAR UVA 7	PAL C	F96 T12
PAL 96HOCUV	CLEAR UVA 7	PAL C	F96 T12
PAL 96VHOCUV	CLEAR UVA 7	PAL C	F96 T12
PAL 18T8 CUV	CLEAR UVA 7	PAL T8	F15 T8
PAL 36T8 CUV	CLEAR UVA 7	PAL T8	F25 T8
PAL 40T8 CUV	CLEAR UVA 7	PAL T8	F32 T8
PAL 96T8 CUV	CLEAR UVA 7	PAL T8	F96 T8
<b>Replacement End Caps</b>			
PAL C	BLACK	ALL T12	-
PAL T8	BLACK	ALL T8	-
<b>Replacement Heat Sink Screens</b>			
PAL HS	OPEN MESH	T12	-

**To Order:** Replace suffix letter for Clear (C) with Red (R), Green (GR), Blue (B), Pink (P), Gold/Amber (G) or Bug Light Yellow (Y).

**Note:** For Yellow UV, replace suffix letter for Clear UVA (CUV) with Yellow (YUV). T12 Lamp only.

**Example:** PAL40R

**WARNING:** It is safe to use protective sleeves (PAL's) with T8 lamps when used **only** with the following compatible components.

- When T8 lamps are used in conjunction **with** electronic high efficiency ballasts **that are designed to prevent overheating at "end of life" of the lamp.**
- When T8 lamps are operated by **electromagnetic ballasts.**

A.L.P. Lighting Components, Inc. **does not** recommend using protective sleeves (PAL's) on T8 lamps under any other conditions.

PAL C

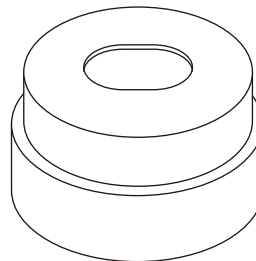

PAL T8

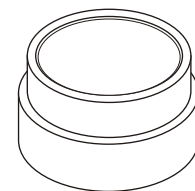

**Note:** Two End Caps are supplied with each sleeve.

Two PAL HS Heat Sink Screens are supplied with each HO and VHO sleeve.



**A.L.P.**  
LIGHTING COMPONENTS, INC.  
CORPORATE HQ: CHICAGO, IL U.S.A.

**For Customer Service and Support Contact us at:**

(877) ALP-LTG1 • Fax: (800) 438-2500 • [www.alplighting.com](http://www.alplighting.com)

© 2003 A.L.P. LIGHTING COMPONENTS, INC., PRINTED IN THE U.S.A., PAL 068