

KEY FEATURES

- Water and air resistant
- Simple installation around in-place cables
- No tools required
- Seals all types of innerduct conduits
- Easy to retrofit
- Riser cable support
- Wide cable sealing range
- Install and remove by hand

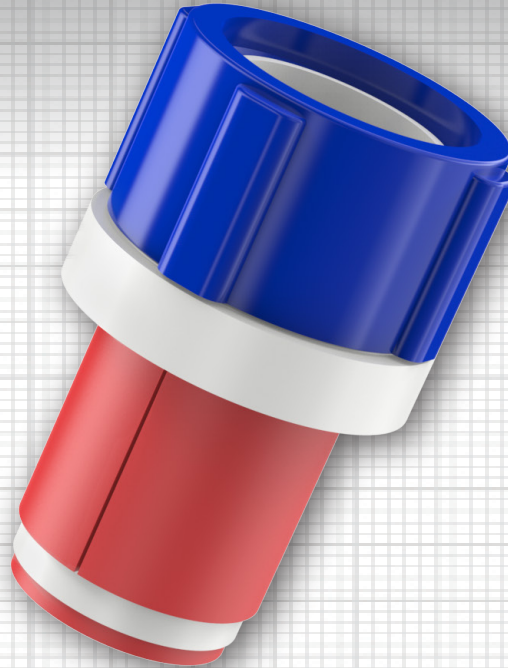

JackMoon[®]
Sealing Devices

JackMoon Fiber Optic Simplex plugs to secure, protect, and terminate new or existing fiber optic cabling

A tried and true design, JackMoon[®] Fiber Optic Simplex plugs effectively organize and seal conduits containing one line.

Designed for applications involving fiber optic cable placement in subduct, they are also ideal for sealing coax or twisted pair cable. Fiber optic simplex plugs are reusable and retrofittable allowing them to be used in applications facing modernization. The expandable, rubber gasket conforms to and contracts around the cable, preventing the incursion of water, air, and dust into the duct system or building.

Many of our sizes are JackMoon certified cross-referenced for a seamless part number conversion.



Supplied by **Professional Plastics**

800.966.PROS

ProfessionalPlastics.com

For product inquiries, email ductbankquotes@proplas.com

SPECIFICATIONS

PRODUCT NUMBER	JACKMOON® CROSS REFERENCE NUMBER	EACH SIZE	CONDUIT INNER DIAMETER	PORT DIAMETER RANGE	CASE QUANTITY
7110-027-035	N/A	1.00"	1.05" - 1.13"	0.27" - 0.35"	20
7110-035-057	JM-SIM-10S057SB*	1.00"	1.05" - 1.13"	0.35" - 0.57"	20
7110-051-071	JM-SIM-10S070SB*	1.00"	1.05" - 1.13"	0.51" - 0.71"	20
7111-020-035	JM-SIM-11S035SB*	1.10"	1.13" - 1.23"	0.20" - 0.35"	20
7111-035-057	JM-SIM-11S057SB*	1.10"	1.13" - 1.23"	0.35" - 0.57"	20
7111-051-071	JM-SIM-11S070SB*	1.10"	1.13" - 1.23"	0.51" - 0.71"	20
7112-035-057	JM-SIM-12S057SB*	1.25"	1.28" - 1.36"	0.35" - 0.57"	20
7112-051-071	JM-SIM-12S070SB*	1.25"	1.28" - 1.36"	0.51" - 0.71"	20
7112-071-084	JM-SIM-12S090SB*	1.25"	1.28" - 1.36"	0.71" - 0.84"	20
7113-012-043	JM-SIM-13S043SB*	1.375"	1.40" - 1.50"	0.12" - 0.43"	20
7113-035-057	JM-SIM-13S057SB*	1.375"	1.40" - 1.50"	0.35" - 0.57"	20
7113-051-071	JM-SIM-13S070SB*	1.375"	1.40" - 1.50"	0.51" - 0.71"	20
7115-008-035	JM-SIM-15S035SB*	1.50"	1.46" - 1.56"	0.08" - 0.35"	20
7115-035-057	JM-SIM-15S057SB*	1.50"	1.46" - 1.56"	0.35" - 0.57"	20
7115-051-071	JM-SIM-15S070SB*	1.50"	1.46" - 1.56"	0.51" - 0.71"	20
7116-051-071	JM-SIM-15S070AB*	1.60"	1.56" - 1.70"	0.51" - 0.71"	20
7116-071-090	JM-SIM-15S090SB*	1.60"	1.56" - 1.70"	0.71" - 0.90"	20
7120-008-014	JM-SIM-20S020SB*	2.00"	1.92" - 2.06"	0.08" - 0.14"	20
7120-015-024	JM-SIM-20S020SB*	2.00"	1.92" - 2.06"	0.15" - 0.24"	20
7120-025-051	JM-SIM-20S043SB*	2.00"	1.92" - 2.06"	0.25" - 0.51"	20
7120-052-075	JM-SIM-20S070SB*	2.00"	1.92" - 2.06"	0.52" - 0.75"	20
7120-076-100	N/A	2.00"	1.92" - 2.06"	0.76" - 1.06"	20

ABOUT CAL AM MANUFACTURING

Cal Am Manufacturing® specializes in products for use in underground electrical and broadband applications. Founded in Southern California over 35 years ago, Cal Am designs and produces fittings and sealing devices to serve utilities, municipalities, government facilities, data centers, and fiber optic projects, through a worldwide network of distributors.

ORDERS & INQUIRIES: CONTACT PROFESSIONAL PLASTICS TODAY!

Professional Plastics, Inc. is a global distributor of Cal Am products.

CONTACT US AT:
800.966.PROS
ductbankquotes@proplas.com

ORDER ONLINE:
professionalplastics.com